



## ASUH SERIES 4-20mA HYBRID PRESSURE TRANSDUCER

The ASUH Series of High Performance Sub-Miniature Pressure Transducers have been designed for demanding high temperature installations in precision engineering. The new design utilises miniaturised hybrid components, allowing savings in both size and weight.

This transducer has enhanced performance at elevated temperature and is optimised for extreme installations such as on-engine or transmissions. With a modular construction and programmable amplifier, this provides a fast delivery time for standard and custom configurations.

Pressure ranges are available between 1 to 400 Bar in either Absolute or Sealed Gauge reference. Industry standard 2-wire electrical connections allow configuration with most common ECU's and data logging systems.

### TECHNICAL SPECIFICATIONS

Product Range	≤50 bar	>50 bar
Pressure Reference	Absolute or Sealed Gauge	
Standard Pressure Ranges (bar)	1 to 50 (see configurator)	100 to 400 (see configurator)
Proof Pressure (Over range)	200% of Range	
Burst Pressure	>500% of Range	
Accuracy (CNLH)	±0.08% FS	±0.25% FS
Thermal Accuracy	<±0.25% FS TEB within Compensated Range	Zero ±0.02% FS/°C (Sensitivity ±0.02% of Reading /°C)
Output	4-20mA (±0.5%)	
Supply	9-40Vdc	
Operating Temperature Range	-40°C to +150°C	
Compensated Temperature Range	0 to 125°C	
Bandwidth	0-1000Hz (Standard) - Other Frequencies Available	
Construction	17-4 Stainless Steel	
Electrical Connection	26AWG, 55 Spec Wire + DR25 Sleeve Or, Hermetic Connector: 8STA1-Y02-05PN170	Hermetic Connector: 8STA1-Y02-05PN170
Process Connection (Thread Size)	Please See Part Number Configurator	
Protection Class	IP67 (Cable Option), Hermetic Seal (Connector)	
Weight	Cable Option: 27g Connector Option: 21g	

KA Sensors adopts a continuous development program which sometimes necessitates specification changes without notice.

PRESSURE | TEMPERATURE | FORCE | POSITION | SPEED | ACCELERATION

## Sensors For Motorsport

### Features

- Sub-Miniature Size
- 4-20mA Output
- 1 to 400 Bar Range
- Cable or Connector
- 0-1000Hz Bandwidth
- ±0.08% Accuracy

### Applications

- Coolant
- Brakes
- Water
- Boost
- Fuel
- Oil

### Contact us

kasensors.com

sales@kasensors.com

ASUH 4-20mA

11.23

KA001P-DS

## MECHANICAL DETAILS

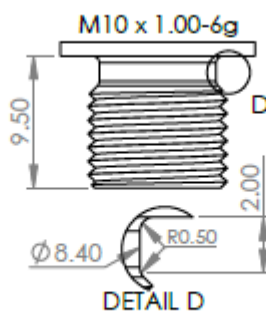
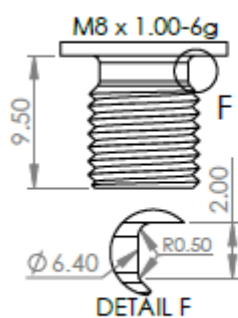
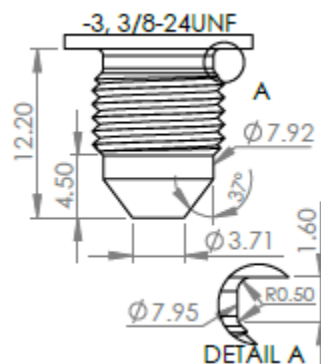
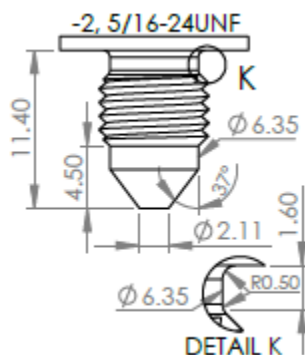
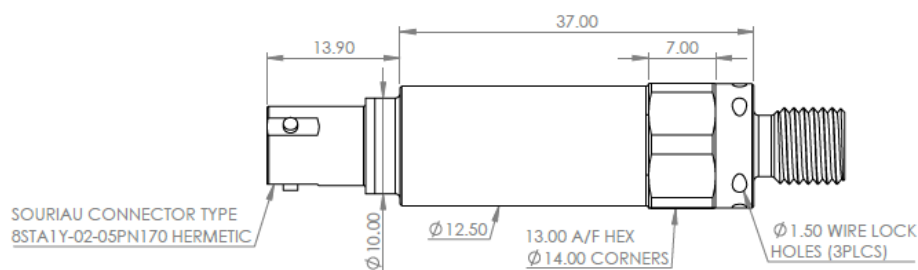
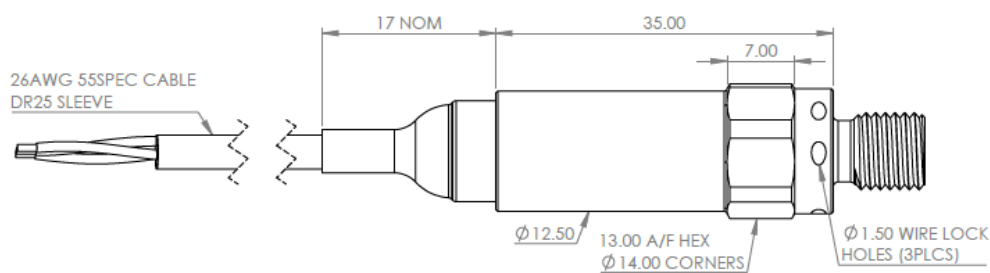

*Sense  
Analyse  
Control*

Contact us

[kasensors.com](http://kasensors.com)

[sales@kasensors.com](mailto:sales@kasensors.com)

ASUH 4-20mA

11.23

KA001P-DS

## PART NUMBER CONFIGURATOR

### Pressure Reference

### Pressure Range

### Compensated Temperature Range (CTR)

### Electrical Connection

### Process Connection

### Special Code

**ASUH** -   -

Absolute Sealed Gauge — A — S

1 Bar — 1000  
2 Bar — 2000  
10 Bar — 1002  
20 Bar — 2002  
35 Bar — 3502  
50 Bar — 5002  
100 Bar — 1003  
200 Bar — 2003  
400 Bar — 4003

Hermetic Connector Option Only {

Standard 0°C to +125°C — 1

26AWG, 55 Spec Wire + DR25 Sleeve — A  
Hermetic Connector. 8STA1-Y02-05PN170 — 5PN

3/8 Inch 24 UNF Dash 3 (SAE J514) — A  
M10 x 1 Male (ISO 6149-2) — D  
M8 x 1 Male (ISO 6149-2) — F  
5/16 Inch 24 UNF Dash 2 (SAE J514) — K

None — 000

## CONNECTION DETAILS

Function	+Ve Supply	GND	Factory Use Only
Cable Option Wire Colour	Red	Black	White
Connector Option Pin-Out	Pin 1	Pin 2	Pin 3

## OUTPUT DETAILS

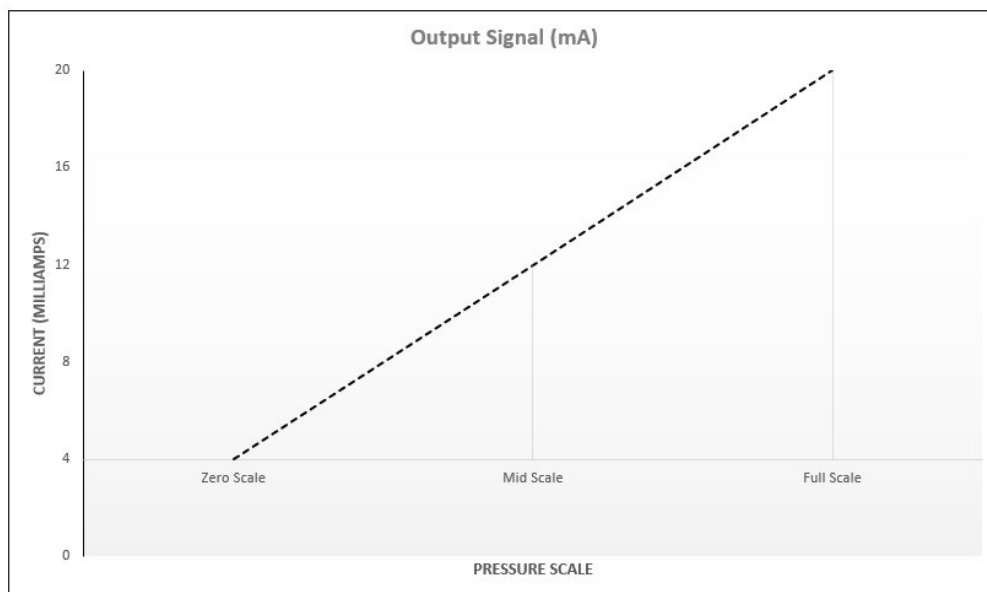

*Sense  
Analyse  
Control*

### Contact us

[kasensors.com](http://kasensors.com)

[sales@kasensors.com](mailto:sales@kasensors.com)

ASUH 4-20mA

11.23

KA001P-DS